

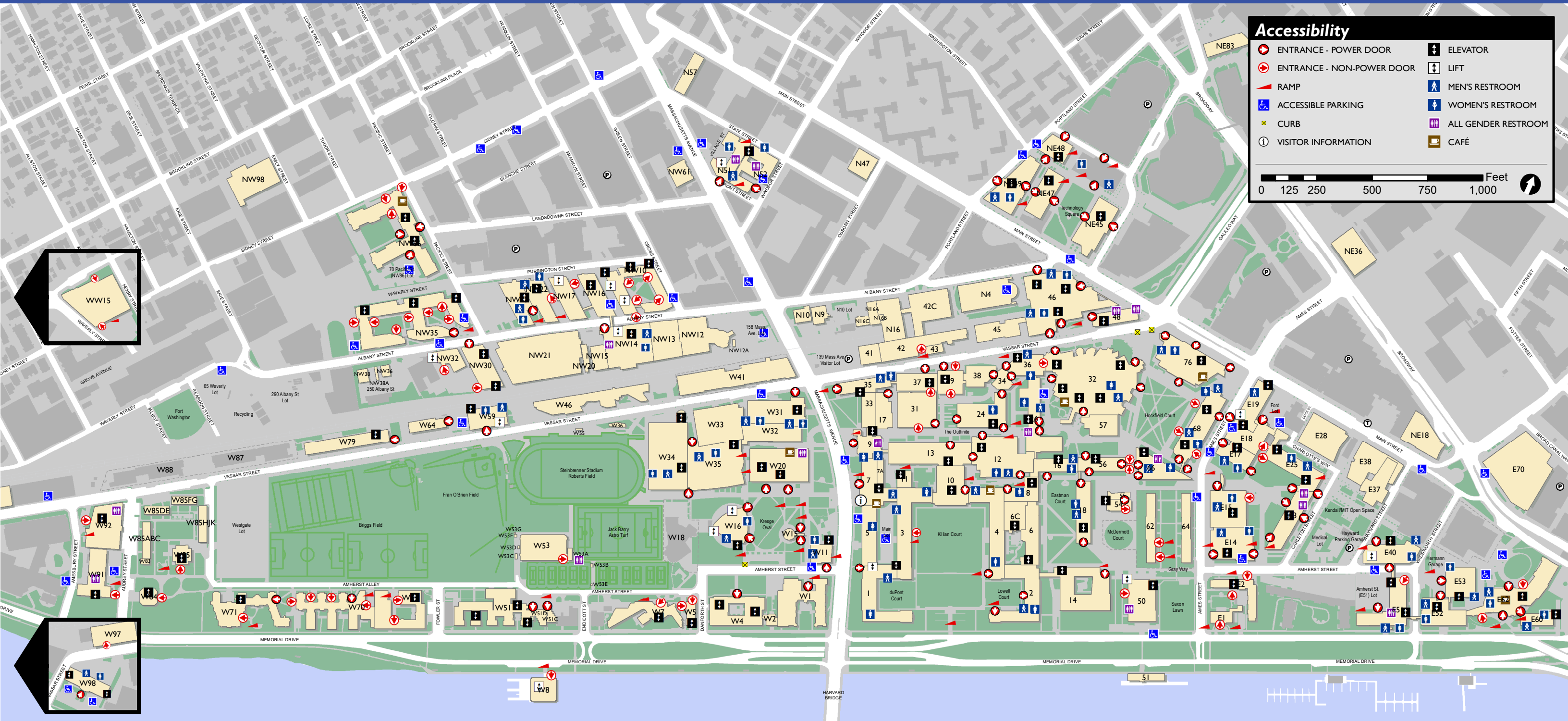

MIT CAMPUS ACCESSIBILITY MAP



Accessibility

	ENTRANCE - POWER DOOR		ELEVATOR
	ENTRANCE - NON-POWER DOOR		LIFT
	RAMP		MEN'S RESTROOM
	ACCESSIBLE PARKING		WOMEN'S RESTROOM
	CURB		ALL GENDER RESTROOM
	VISITOR INFORMATION		CAFÉ

0 125 250 500 750 1,000 Feet

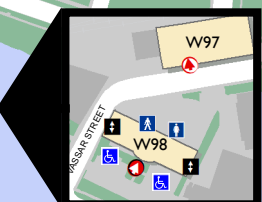
Access to MIT
 This guide presents the major means of physical access to MIT facilities, as well as the architectural barriers which may be encountered. Although this guide deals with the general needs of people with temporary or permanent mobility impairments, MIT is prepared to respond to other access requests.

Architectural Barriers
 If you encounter any barriers or have any requirements or recommendations relating to the physical environment, contact:
 MIT Facilities | NW23-100 | 617-253-4948
 HR Disabilities Services Office | NE49-5000 | 617-253-4572
 Disabilities Services for Students | 5-104 | 617-253-1674

Parking
 Parking at MIT is by permit only. Designated accessible parking also requires an HP plate. If you do not have an HP Plate and special parking arrangements are required, you may contact:
 MIT Parking & Transportation Office | E17-106 | 617-258-6510
 MIT Medical Occupational Health | E23-171 | 617-253-8552

Snow Removal
 If additional snow removal is needed contact:
 Grounds Services | NW38 | 617-253-5718

Department of Athletics, Physical Education and Recreation (DAPER)
 W34/W35 Main Customer Service Desk | 617-253-4498

Housing
 617-253-2811













Inaccessible Buildings
 Random Hall, NW61 | Sailing Pavilion, 51

Visitor Information  (M-F, 9AM - 5PM)
 For copies of this map or more information about MIT, please visit the MIT Information Center, Room 7-121, located in the main entrance lobby (Lobby 7) | 617-253-4795

MAIN GROUP ACCESSIBILITY

Many of the **MAIN GROUP** and **NORTH GROUP** buildings are interconnected to allow access between buildings. The maps on this page depict these connections for floors basement through five. Please note that floors in the **MAIN GROUP** are numbered one floor lower than **NORTH GROUP** floors at the same level.

LEGEND

-  ENTRANCE - POWER DOOR
-  ENTRANCE - NON-POWER DOOR
-  RAMP
-  ACCESSIBLE PARKING
-  CAFÉ
-  VISITOR INFORMATION
-  ELEVATOR
-  LIFT
-  WOMEN'S RESTROOM
-  MEN'S RESTROOM
-  ALL GENDER RESTROOM
-  ACCESSIBLE ROUTES THROUGH BUILDINGS
-  ACCESSIBLE ROUTES THROUGH TUNNELS



MIT CAMPUS ACCESSIBILITY MAP

BASEMENT

NORTH GROUP

MAIN GROUP

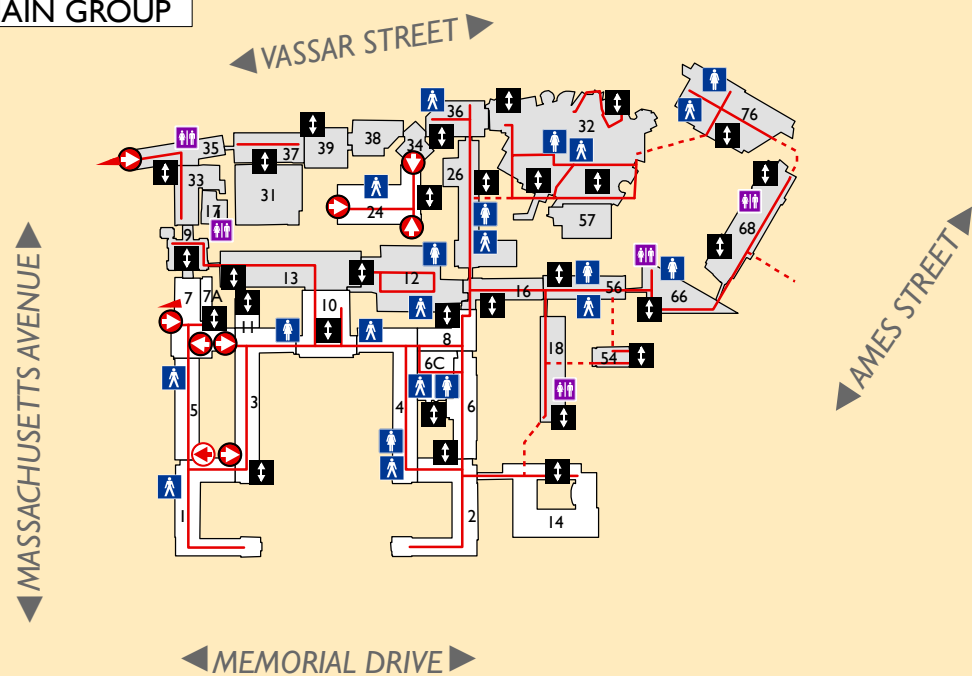

FLOOR 1

NORTH GROUP

MAIN GROUP

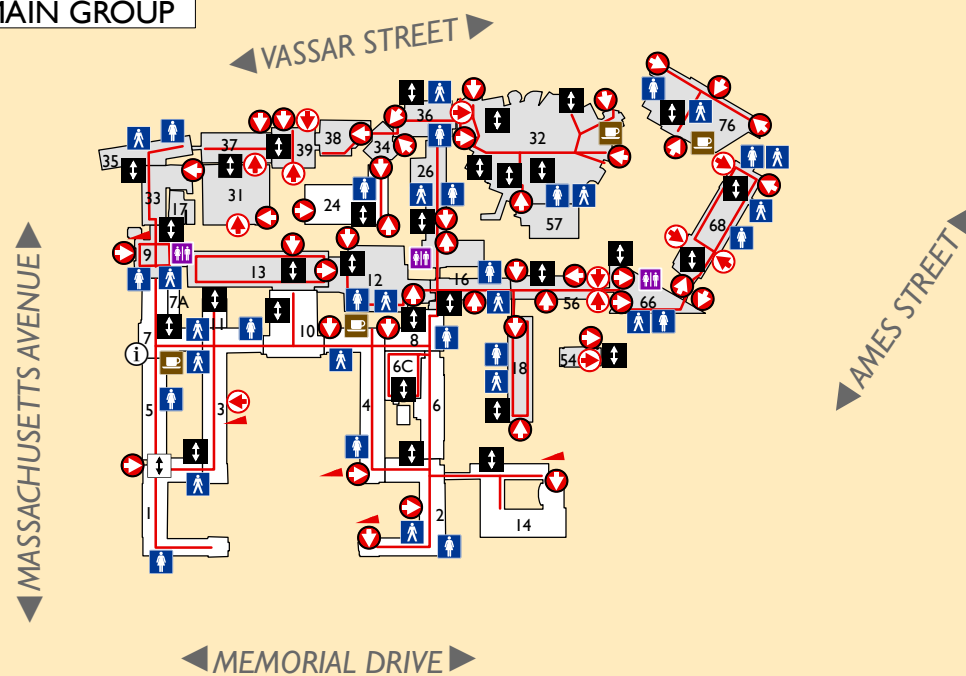

FLOOR 2

NORTH GROUP

MAIN GROUP

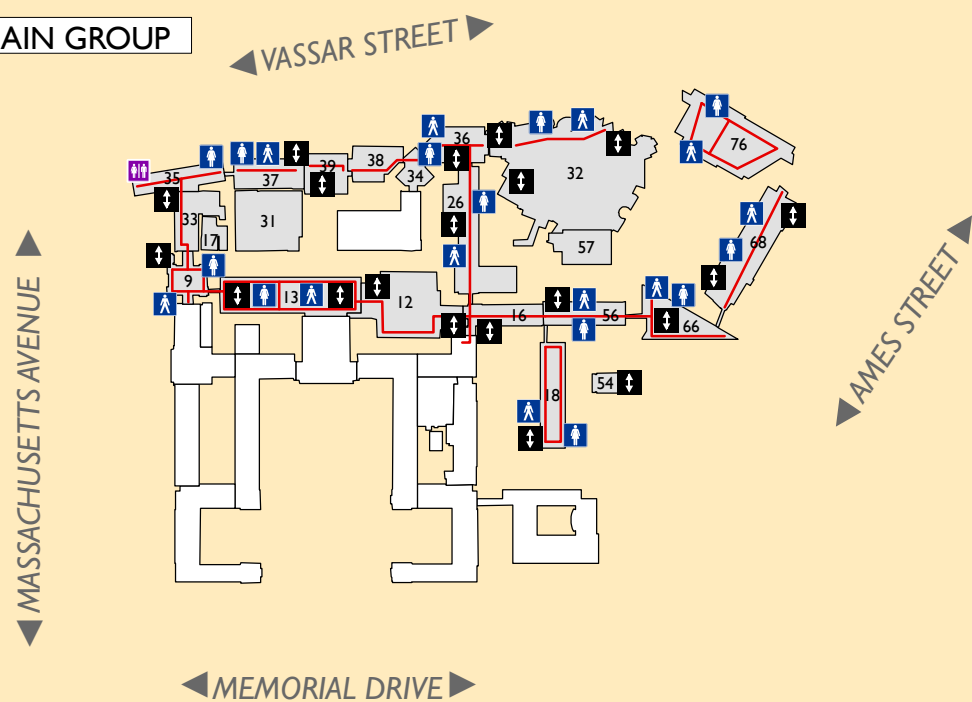

FLOOR 3

NORTH GROUP

FLOOR 2

MAIN GROUP

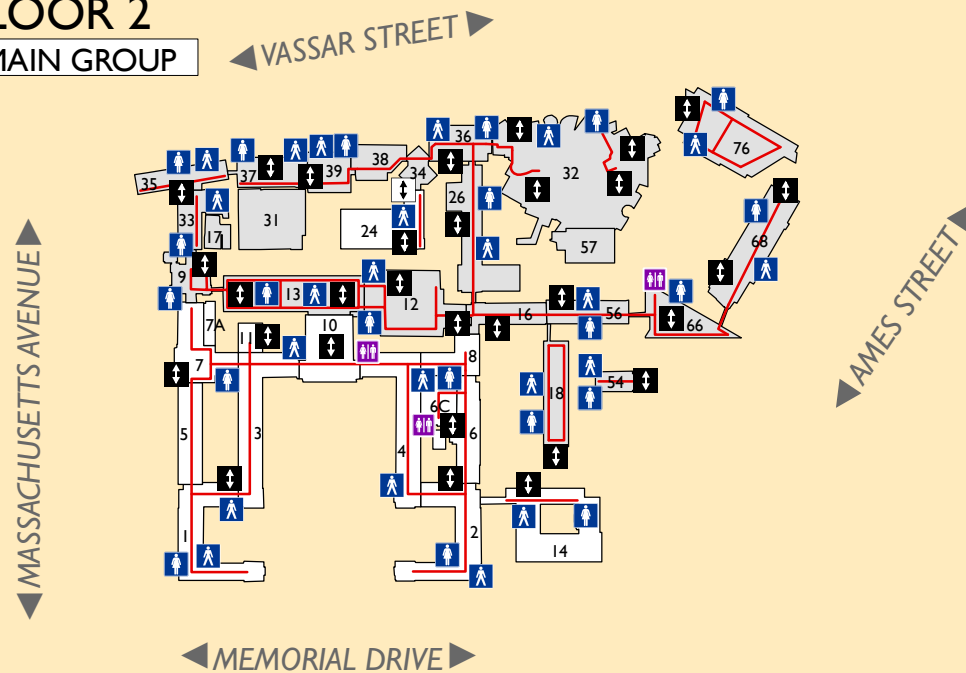

FLOOR 4

NORTH GROUP

FLOOR 3

MAIN GROUP

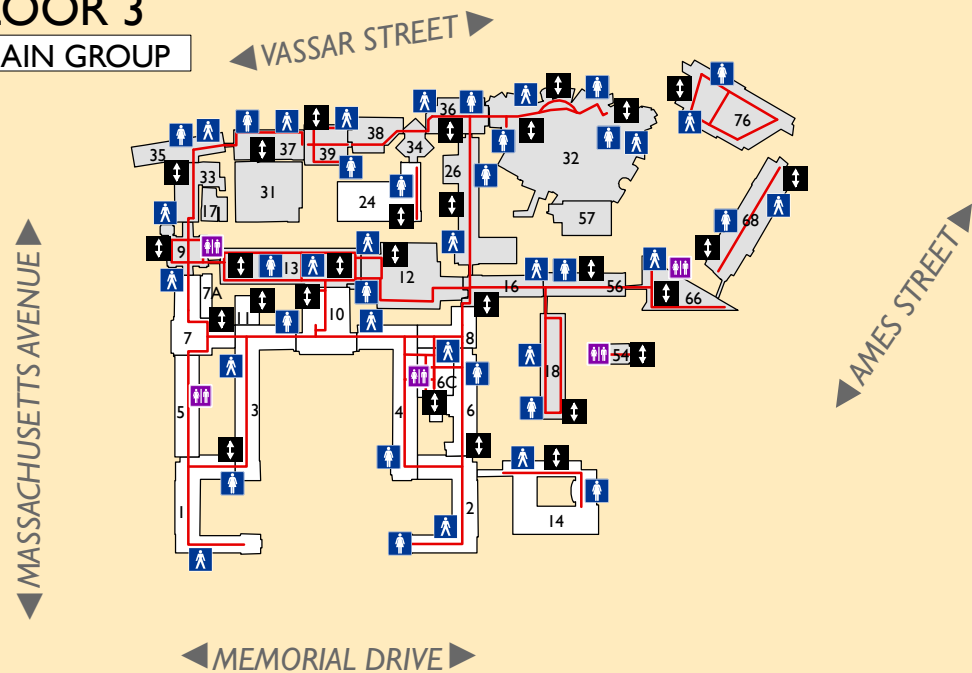

FLOOR 5

NORTH GROUP

FLOOR 4

MAIN GROUP

